



Abhishek Developers
Phone: 98251 25344
Email: aadeshwar2011@gmail.com



KALPVUKSH
ARCHITECT
Parin Shah 99252 07914
Kevin Shah 98796 14629

Structural Designer

Jalilbhai Sheikh
Ph. (0261) 247 2288

Electrical Consultant

Apurva Pathak
Excellent Energy Consultant
Ph. 98251 26330

Plumbing Consultant

Malawawala Engineering
Services Pvt. Ltd
Ph. (022) 4024 4314

Legal Adviser

Arvindbhai L. Patel
Ph. 98251 88253

A Project By



you deserve the best at...





A PREFERRED BUSINESS DESTINATION

A good opportunity doesn't come around very often,
so when it does, make sure you grab it with both hands !





An Ideal Place for
SHOPS, SHOWROOMS, OFFICES, HOSPITAL,
RESTAURANT BANK, HEALTH CLUB, SUPER STORE &
many more other business lines...



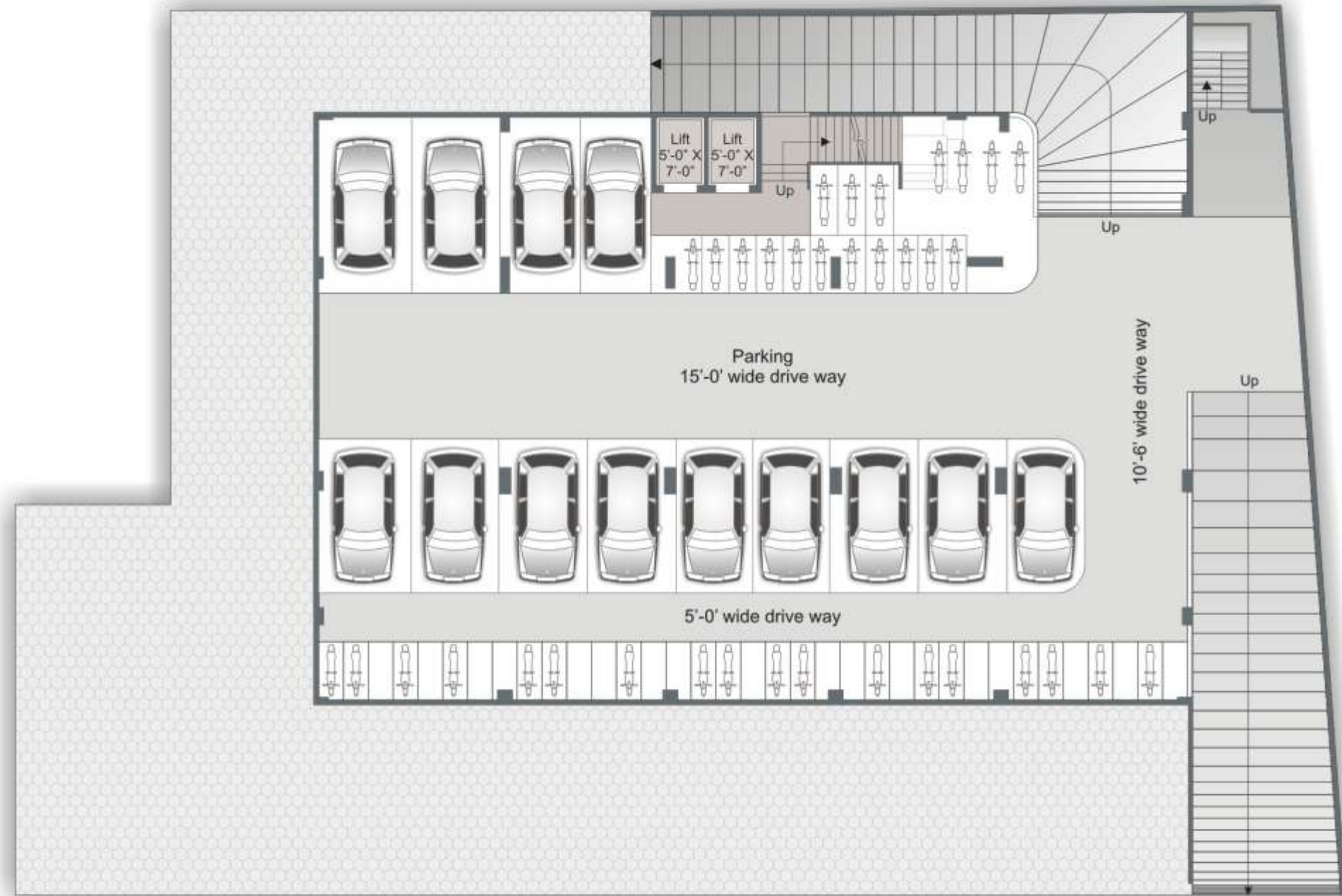

Basement Floor Plan

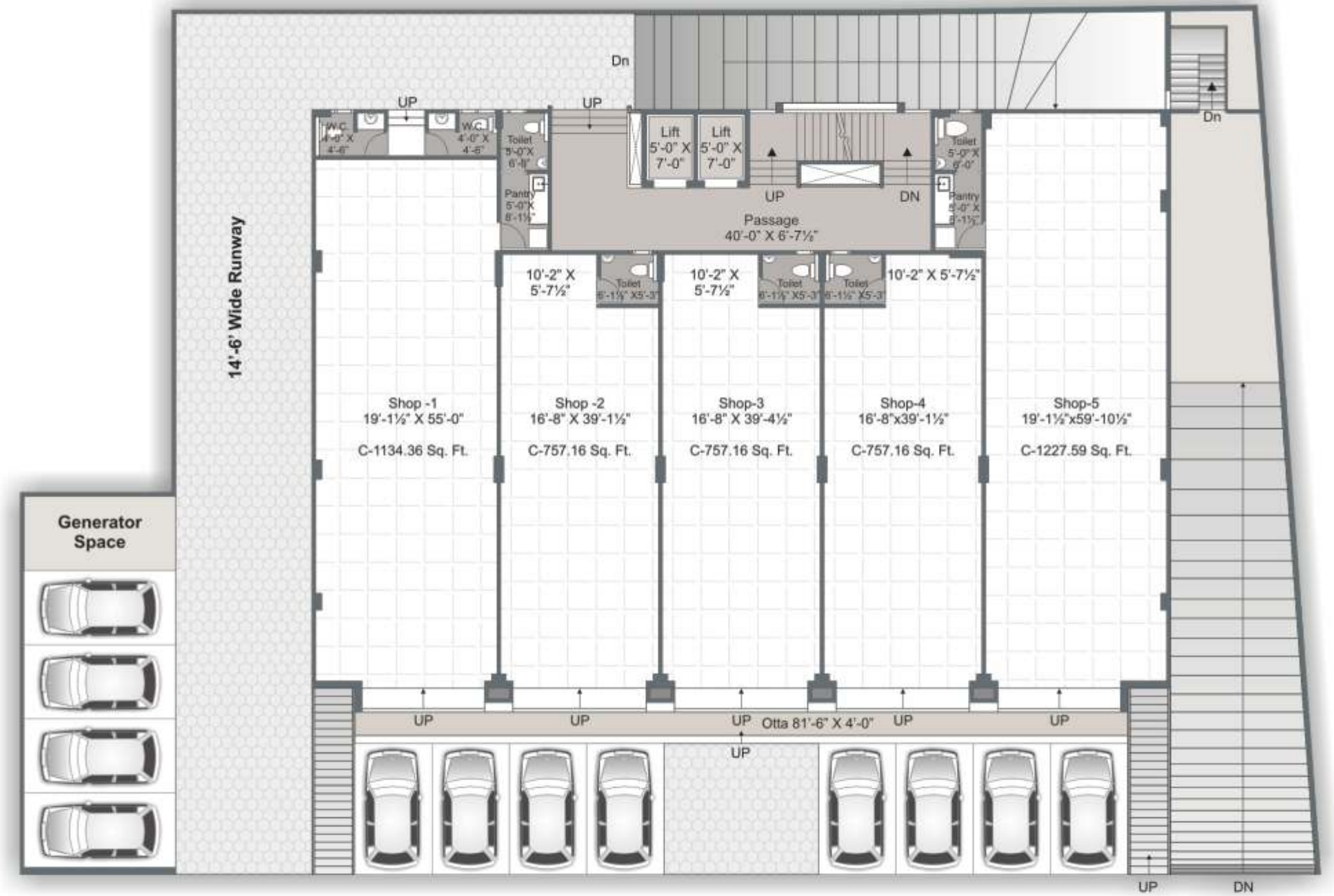

Ground Floor Plan

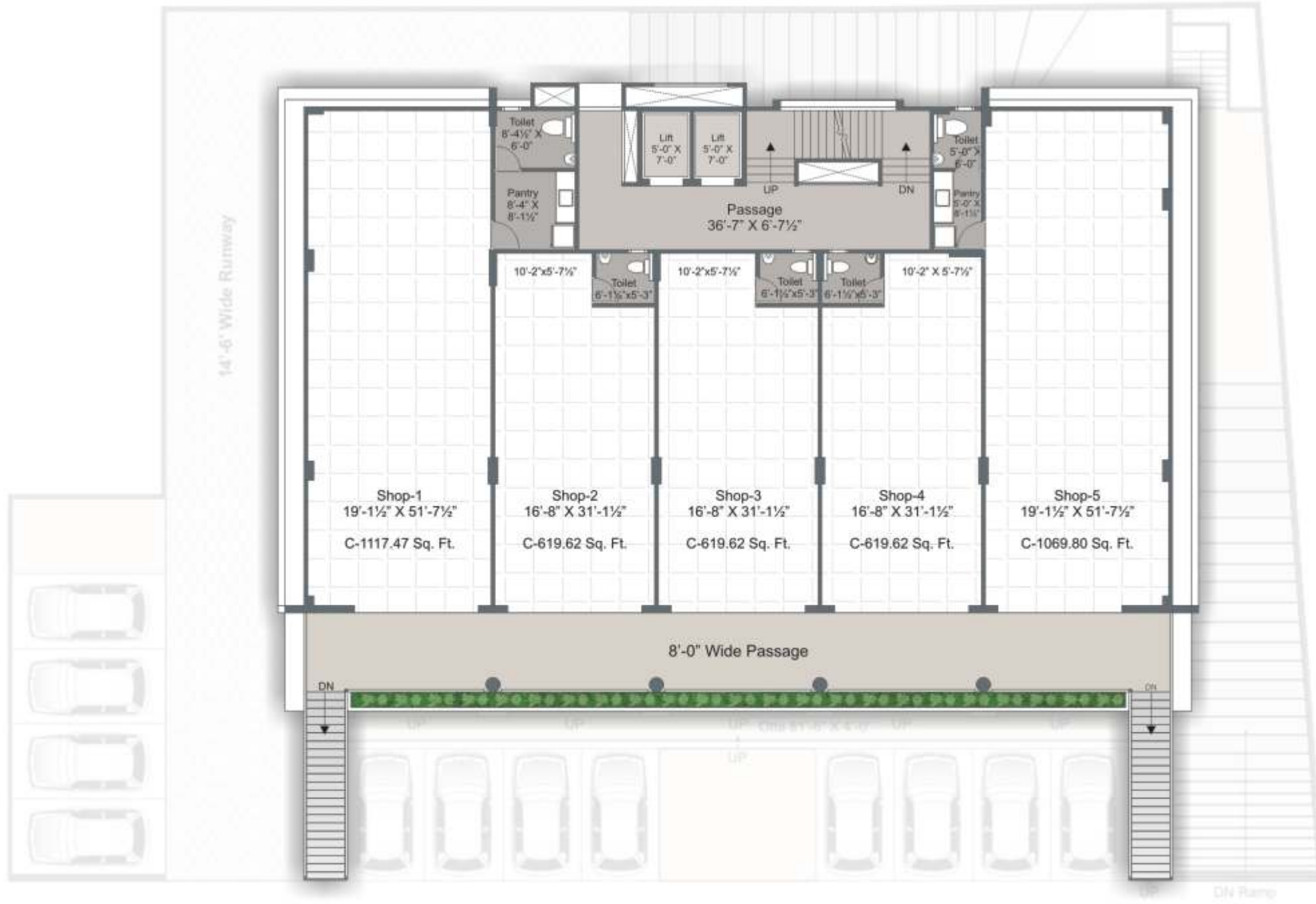

First Floor Plan

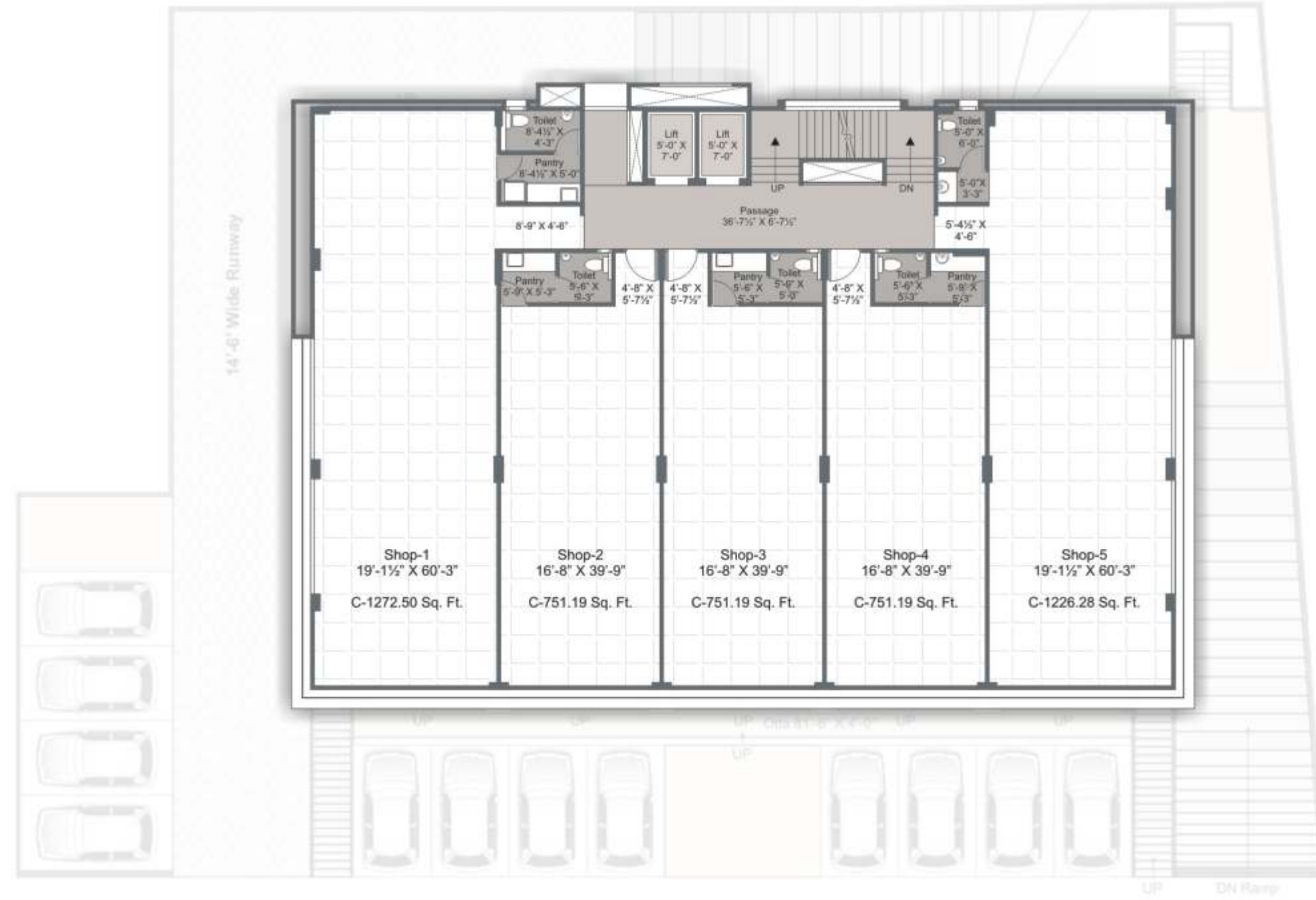

Typical Floor Plan
(2nd to 4th)

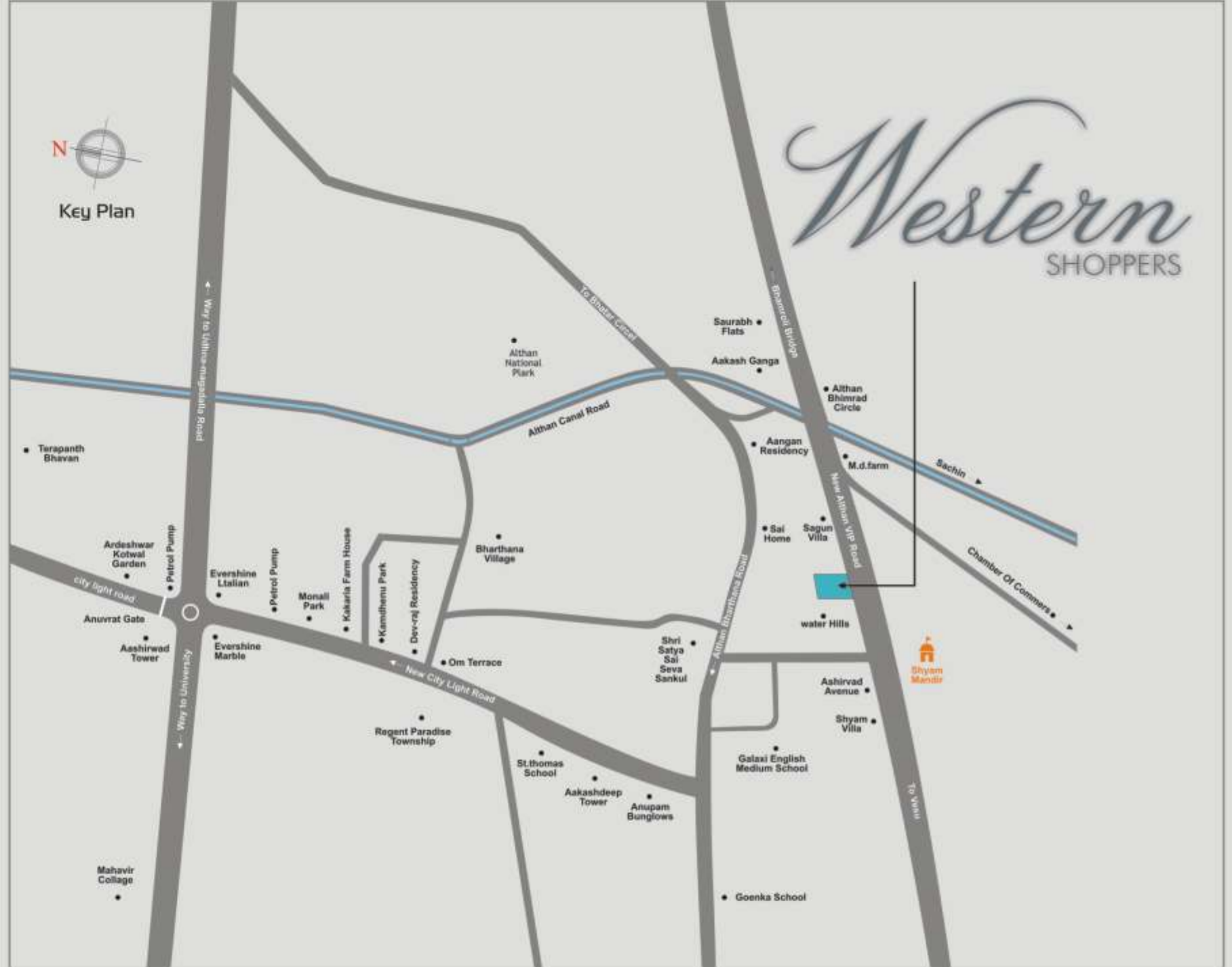

Specification-Internal common area

- Shops
2'-0" x 2'-0" Granamite tile flooring at all floors.
- Toilets & Pantries
Flooring & Dado of 2'-0" x 2'-0" Granamite. All sanitary fittings of Cera, Hindware, & plumbing fittings of Plumber or equivalent make.
- Lift cladding
Granamite & Italian wall cladding at each floor near passenger lift entrances.
- Staircase
Granite stone flooring on steps & landing.
- Passages
2'-0" x 2'-0" Granamite tile flooring at all floors.

- Electrification
Shop area with basic wiring including complete Air conditioner load, Tata sky connection, internet points & 100% power backup for passage area, Lift, common area and surroundings of building.

Specification-External area

- Parking
Ground floor parking finished with V.D.S (Tri-mix rough finish) / Paver of good quality
Basement floor parking finished with V.D.S (Tri-mix rough finish) & ramp with kota strip.
- Building exterior
External surface in fully glazing.

Note :

1. All right are reserved by the developer.
2. All right reserved by the developer to make any changes in specification, plan, Elevation etc.
3. changes in internal or external elevation will not be allowed.
4. This information book is the property of developer. It cannot be used as a legal document or reproduce without their permission.
5. Legal charges, stamp duties, registration charges, service tax, GEB, SMC, suda & gas connection charges etc. to be borne by the members.
5. Any new taxes announced by the government / SMC / Authority will be borne by the member / buyer during the project.
7. Subject to surat jurisdiction.