

{ Uncrowd your life }



0261_98251 10474

ARCHITECTS



Sanjay Josshi
Annie Besent App.,
Soni Falla, Surat.
Tel : 0261 25967257-28
e-mail : sanjayjosshi@yahoo.com

Str. Engineer
jalil A. Shekh
Ring Road, Surat.

Booking
At Site Office

Veerbhadr
Avenue

Step inside The **Veerbhadra Avenue's** latest exclusive property development soon to become one of **Adajan's** most desirable addresses

A leading real estate group

A conglomerate known for its commitment

The name epitomises world-class infrastructure

development Strives to offer its clients all the

luxuries of a modern living.



Basement

Floor Plan

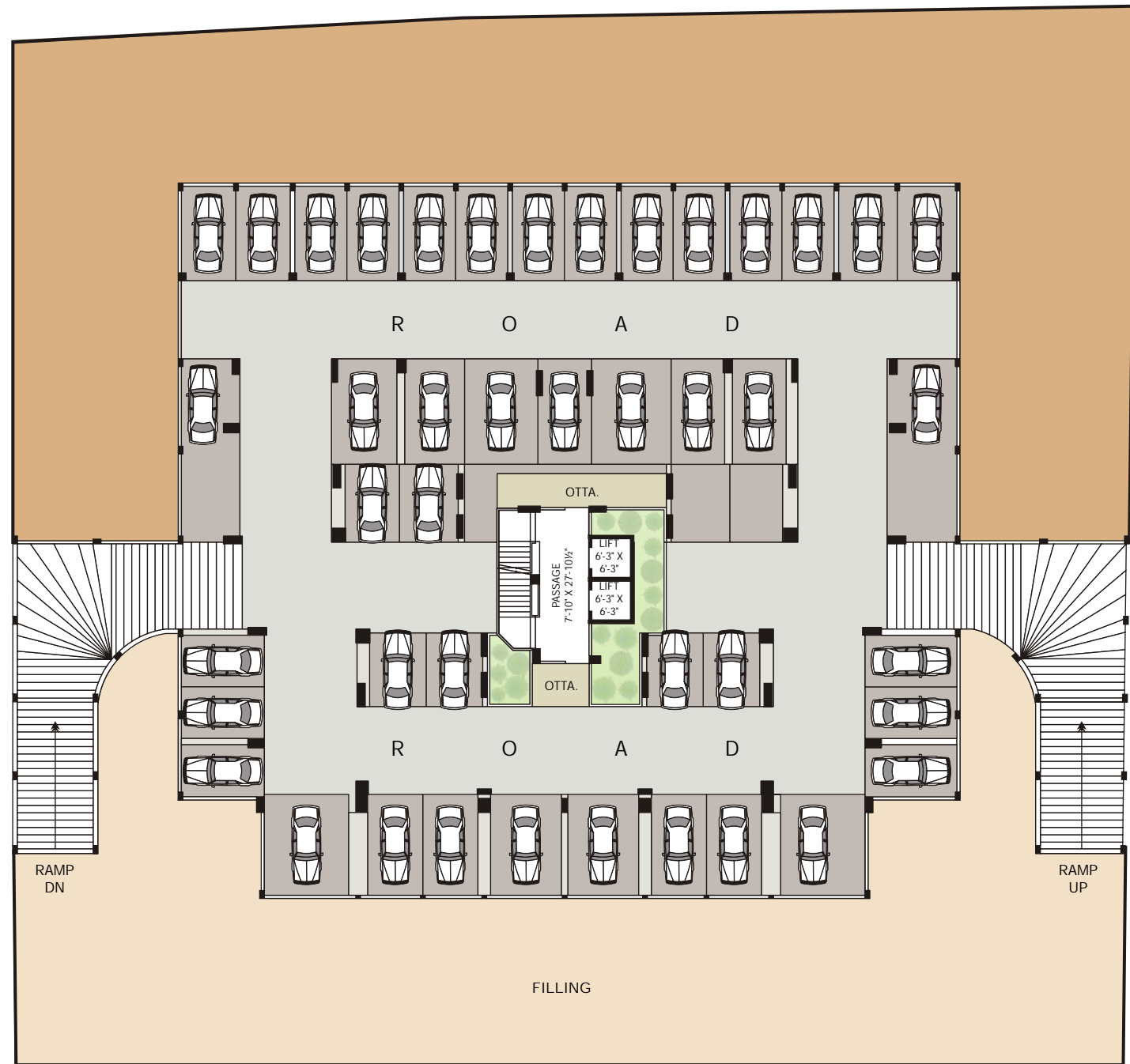

Ground

Floor Plan





Typical Floor Plan



Internal Unit Finishes

FLOORING

- 2'-0" X 2'-0" Granamite tiles in Ground floor shop.
- 2'-0" X 2'-0" Granamite tiles in living, Dining & kitchen.
- 2'-0" X 2'-0" Granamite tiles flooring in bed rooms.

KITCHEN

Granite kitchen platform with twin bowl sink of Carrysil and White Tile/Designer Tile Cladding up to lintel level.

PLUMBING

American Standard / Aqual make plumbing fitting & Cera / Parry ware make sanitary ware.

ELECTRIFICATION

Finolex / Polycem cable and Modular switch & other fittings with I.S.I. standard of good Quality.

AIR CONDITION

Individual Split Unit in Two Bed rooms.

DOORS

Flush door Waterproofing shutter with Teak wood Frame.

WINDOWS

Anodized coating Aluminum section window with Reflective Glass of Standard Quality & with Safety Grills.

WALL FINISH

Wall finished with Birla or eq. make White putti.

TOILETS

12" x 24" or 12" x 18" Matt Finish Designer Tiles.

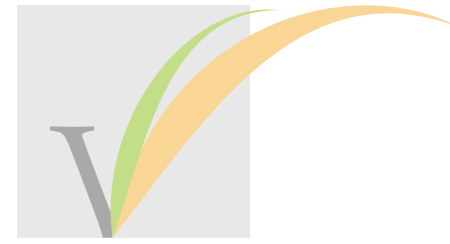

Internal Common Area Finishes

FOYER

Granite/Granamite flooring & Wall Cladding with Marble.

LIFT CLADDING

Granite / Granamite Cladding on lift Entry wall at each floor.

STAIRCASE

Granite tappa in ground & Kotah stone in all other floor.

External open Ground area finishes

MARGINE FINISH

Paver blocks in parking area & V.D.S. (Tri. Mix) in road.

FLOORING IN PLINTH

Rough kotah stone / Vyara make Chequered flooring inside building plinth.

GARDEN

Garden space with seating area and landscape.



Route Map

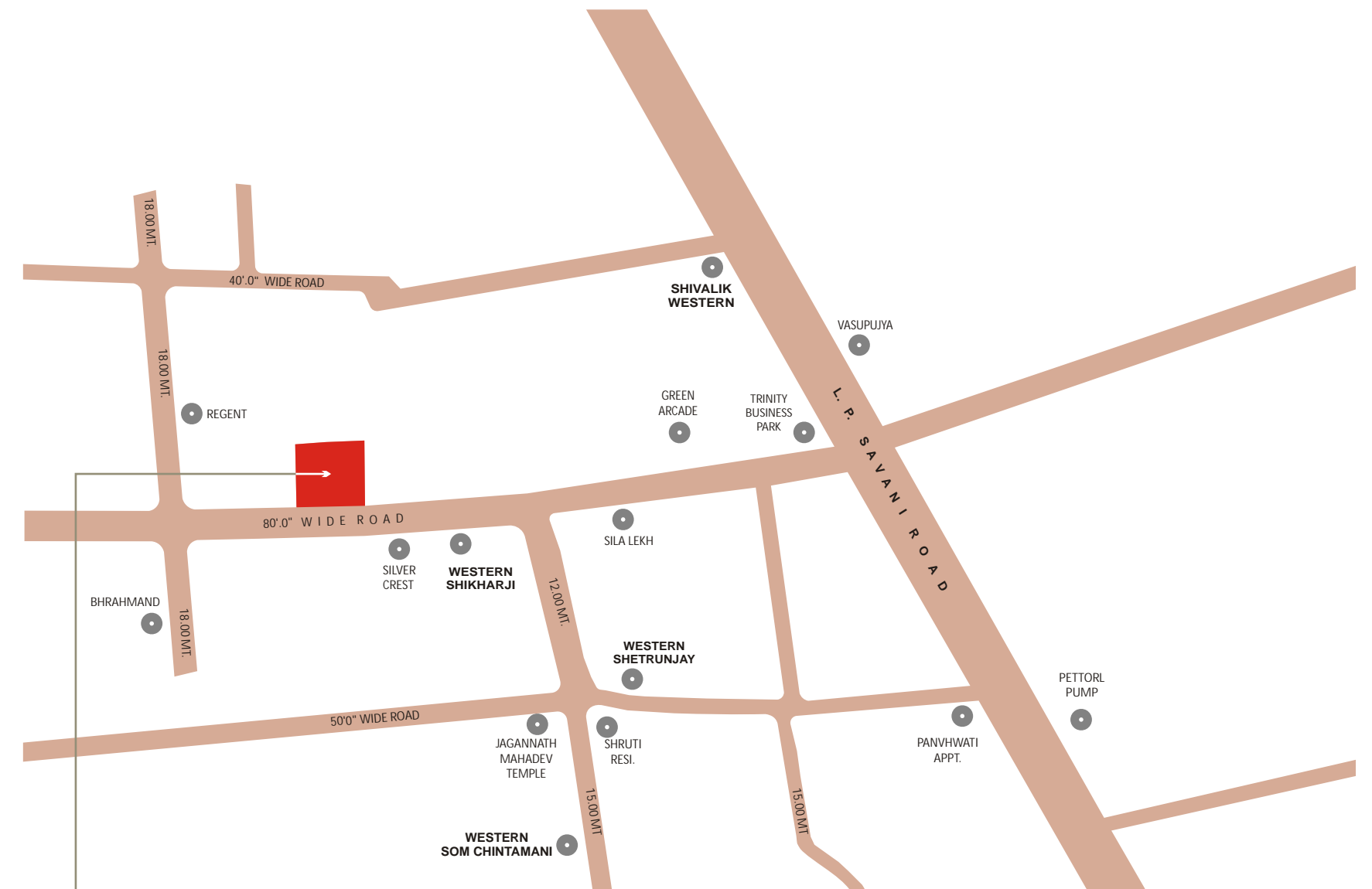

Veerbhadra Avenue

Note :

- All document charges & such as stamp duty, service tax, g.e.b. Charges & other Legal charges are to be born by the members.
- No external changes shall be allowed.
- Internal changes shall be allowed only with prior permission & with extra cost.
- The right to changing the plans fully or partly or specification or amenities mentioned are Reserved with the developer.
- The developer reserves the all rights to make any amendments in construction as may Be necessary.
- All plans, specification or information in this brochure can not form part of an offer Contract or agreement.
- Subject to surat jurisdiction.

Connectivity	
Domestic Air Port	15 Km.
Rail Way Station	8 Km.
Commercial Hub	1.5 Km.
office Blocks	1.5 Km.
School	1.5 Km.
Nearby Petrol Pump	1.5 Km.
Garden	1.5 Km.